

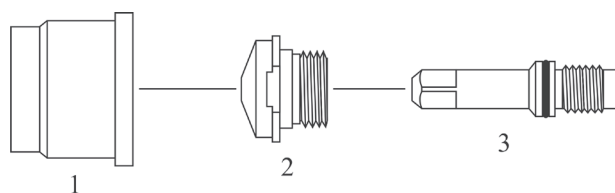

CEBORA®

System: **PROF162®**

Torch: **CP200®**



Item	Ref.Number	Order Number	Description
01.	1905	BP-40101	Retaining cap 20A-200A
02.	1842	BP-40102	Nozzle - ø 1,0mm, 20A-50A
	1843	BP-40103	Nozzle - ø 1,3mm, 40A-90A
	1844	BP-40104	Nozzle - ø 1,6mm, 80A-120A
	1845	BP-40105	Nozzle - ø 1,8mm, 110A-150A
03.	1367	BP-40106	Electrode 20A-200A