

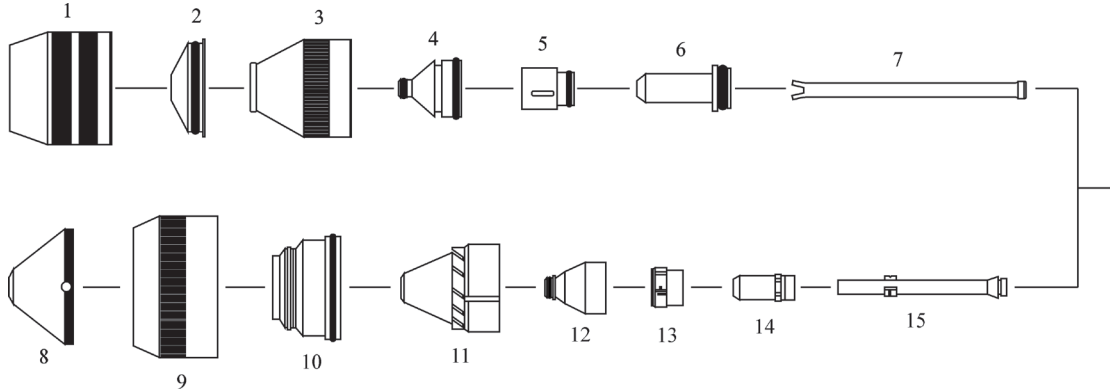

KJELLBERG®

System: *HiFocus 280i-360i-440i®*

Torch: *PerCut 370.1M - cutting up to 160A*



| Item | Ref.Number | Order Number | Description |
|------|-------------------|--------------|-------------------------------------|
| 01. | .11.835.201.081 | BP-30401 | Shield cap Z501 |
| 02. | .11.835.201.1561 | BP-30402 | Shield Z4015 - ø 1,5mm |
| | .11.835.201.1571 | BP-30403 | Shield Z4020 - ø 2,0mm |
| | .11.835.201.1551 | BP-30501 | Shield Z4022 - ø 2,2mm |
| | .11.835.201.1581 | BP-30404 | Shield Z4025 - ø 2,5mm |
| | .11.835.201.1591 | BP-30405 | Shield Z4030 - ø 3,0mm |
| | .11.835.401.1571 | BP-30406 | Shield Z4140 - ø 4,0mm |
| 03. | .11.842.401.160 | BP-30502 | Retaining cap S3004 - ø 0,4mm |
| | .11.842.401.162 | BP-30514 | Retaining cap S3008 - ø 0,8mm |
| | .11.842.401.1622 | BP-30515 | Retaining cap S3028 - ø 0,8mm |
| 04. | .11.843.021.406 | BP-30503 | Nozzle S2006X - ø 0,6mm, 25A, O2 |
| | .11.843.021.407 | BP-30504 | Nozzle S2007X - ø 0,7mm, 35A, O2 |
| | .11.843.021.408 | BP-30505 | Nozzle S2008X - ø 0,8mm, 50A, O2 |
| | .11.843.021.409 | BP-30506 | Nozzle S2009X - ø 0,9mm, 70A, O2 |
| | .11.843.021.410 | BP-30507 | Nozzle S2010X - ø 1,0mm, 80A, O2 |
| | .11.843.021.411 | BP-30508 | Nozzle S2011X - ø 1,1mm, 90A, O2 |
| | .11.843.021.412 | BP-30509 | Nozzle S2012X - ø 1,2mm, 100A, O2 |
| | .11.843.021.414 | BP-30510 | Nozzle S2014X - ø 1,4mm, 130A, O2 |
| | .11.843.021.416 | BP-30511 | Nozzle S2016X - ø 1,6mm, 160A, O2 |
| 05. | .11.835.221.153 | BP-30415 | Swirl ring Z101 - 3 holes (vespel®) |
| | .11.835.221.154 | BP-30512 | Swirl ring Z102 - 2 holes (vespel®) |
| 06. | .11.843.021.320AG | BP-30701 | Cathode S002Y-XL O2 SILVER |
| 07. | .11.842.401.152 | BP-30520 | Cooling tube - PerCut 160/170 |